

SLIDING WINDOWS

# HST 76

**deceuninck**

PREMIUM LIFT-AND-SLIDE  
WINDOW

**The lift and sliding doors made by Deceuninck combine the exceptional quality-of-life features of open architecture while meeting the highest security and stability requirements. The future-proof product that fits neatly into the Elegant platform excels in terms of weather protection, is exceptionally easy to use and can be equipped with functional glass types of up to 52 mm – at a sash depth of just 76 mm.**

- Glazing up to 52 mm: For triple-glazed safety glass and high soundproofing that extends all the way to Class 4
- Five-chamber technology: excellent thermal insulation:  $U_f$  value 1.3 W/m<sup>2</sup>K
- High level of burglary protection (RC2) with special fittings and safety glass available
- One foot glazing bead in two different designs: rectangular and round
- Additional reinforcement: Storey-high elements possible
- Flat threshold for old-building renovation
- Barrier-free threshold available
- Compatible with the Siegenia EcoPass threshold
- Additional co-weldable gasket in the glass rebate
- Small fixed-glazing framework possible
- Simple and effective installation with the fast installation kit
- Large selection of decors and colours / optionally available with aluminium capping

**TECHNICAL CHARACTERISTICS \*****HST 76 \***

Type of sliding window	2-, 3-, or 4-pane/scheme A-C-G
Frame depth	175 mm
Sash depth	76 mm
Glazing thickness	up to 52 mm
Thresholds	pvc/aluminium, barrier-free option possible
Air permeability	class 4
Watertightness	class 9A
Resistance to wind load	class C3
U <sub>f</sub> value	as from 1, 3 W/m²K with pvc treshold as from 2, 1 W/m²K with aluminium treshold
Burglar proof	class RC2
Soundproof R <sub>w</sub>	44 dB (VSG8/14/4/14/VSG8 glass)

\* Height and width of sliding window test element: 2204 mm × 3004 mm.

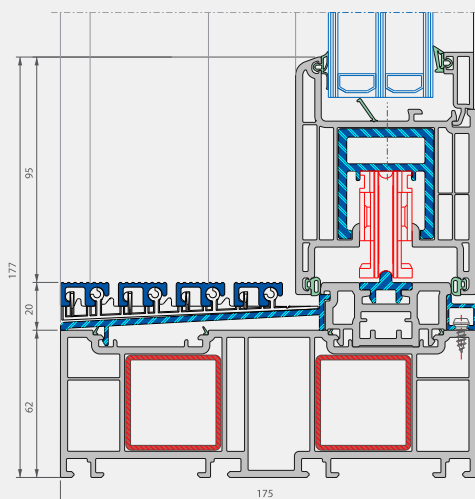

HST 76 vertical section

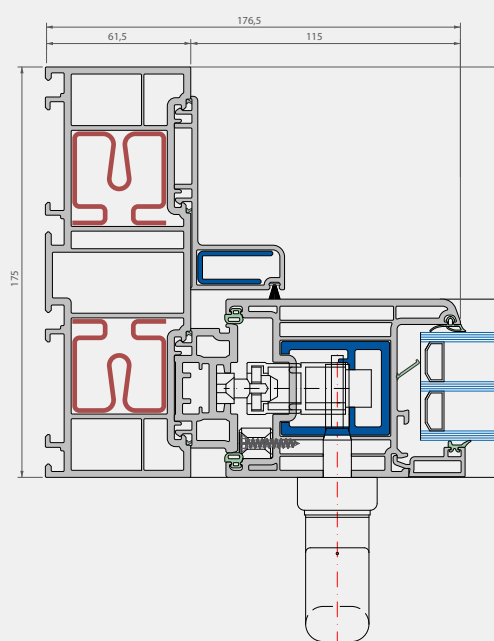

HST 76 horizontal section